

# Thermostat

KTS & KTC Series



## Part Number Description

**KTS & KTC** - **1**

1 Temperature range	30 : -30°C ~ 30°C	50 : 0°C ~ 50°C	90 : 0°C ~ 90°C
	120 : 0°C ~ 120°C (KTS only)	320 : 50°C ~ 300°C (KTS only)	

## General Specification

Rated Current	16A 250VAC	Model	Range	Tolerance	On/Off Difference	Application
Control Temperature Range	-30°C ~ +320°C	KTS-30 KTC-30	-30°C ~ 30°C	±2.5K	2°C ~ 7°C	Freezer, Fish Pond
Life Cycle	Min. 100,000 hrs	KTS-50 KTC-50	0°C ~ 50°C	±3K	2°C ~ 9°C	Shower, Warm Air Blower, Etc
Dielectric Strength	2,500V/1min.	KTS-90 KTC-90	0°C ~ 90°C	±3K	2°C ~ 9°C	Tumbling-Box Washing Machine
Insulation Resistance	Min. 50MΩ	KTS-120	0°C ~ 120°C	±4K	2°C ~ 10°C	Boiling Water Device Smudge Pot
Contact Resistance	Max. 30mΩ	KTS-320	50°C ~ 320°C	±10K	5°C ~ 30°C	Oven, Baking Out

## Dimension

unit : mm

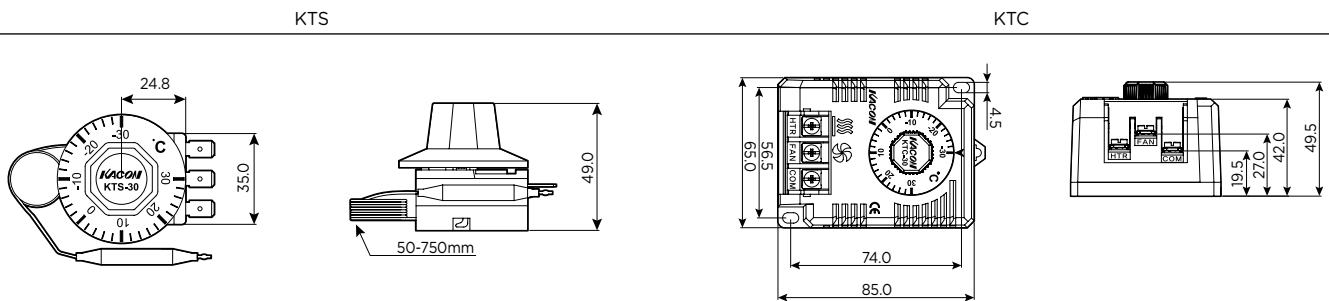

## Diagram

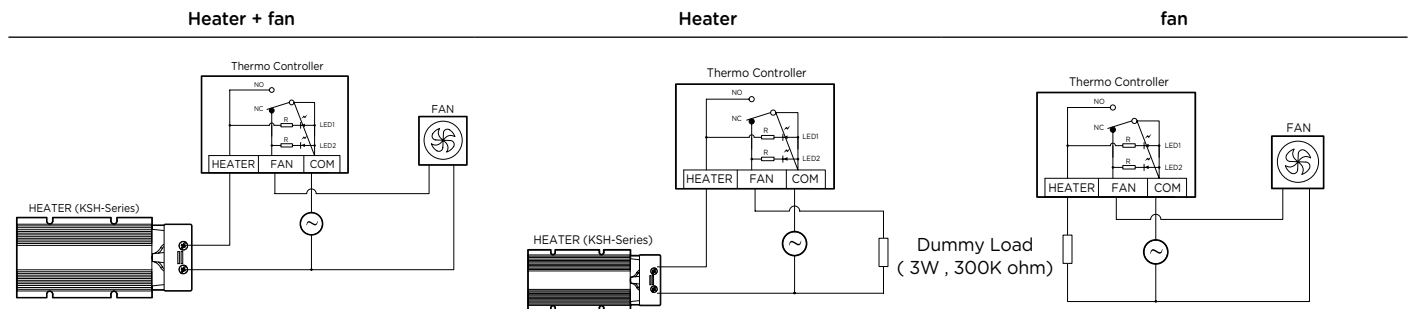

\* Heater or Fan Single operation caution : User shall have dummy load (more than 3W, 300K ohm) as above circuit diagram.  
 \* If the dummy load is not connected it is cause of wrong lamp operation.

## Panel Cut-Out

